

Maintenance

• Save all instructions

A Maintenance Schedule

⚠ WARNING

Before performing any maintenance, turn engine off and remove the wire from the spark plug to prevent accidental starting and serious injury.

IMPORTANT: The warranty on this edger does not cover items that have been subjected to operator abuse or negligence. To receive full value from the warranty, the operator must maintain the edger as instructed in this manual, and only use genuine replacement parts. The following table lists required periodic maintenance.

PERIODIC MAINTENANCE SCHEDULE TABLE

Service Records- Fill in dates as you complete regular service	Before Each Use	After Every 10 Hours of Use	After Every 25 Hours of Use	After Every 50 Hours of Use	After Every 100 Hour of Use	Before Each Season	Before Storage	See Note Below
Check Engine Oil Level, Fill to Proper Level	✓					✓		
Check Connection of BOTH Flameout Wire Connectors	✓					✓		
Clean Debris From Unit	✓					✓	✓	
Lubricate All Pivot Points		✓				✓	✓	
Check Fasteners for Tightness		✓				✓		1
Check Drive Belt Replace if Necessary		✓				✓		
Check Blade for Wear or Damage Replace if Necessary		✓				✓		
Check Fuel Line Replace if Necessary			✓			✓		
Lubricate Wheel Axles			✓			✓	✓	
Check Spark Plug Replace if Necessary			✓			✓		
Change Engine Oil				✓		✓	✓	2,3
Clean Air Filter Replace if Necessary			✓			✓		4
Replace Spark Plug					✓			
Clean Combustion Deposits from Cylinder, Piston, and Valves					✓			

⚠ CAUTION **IMPORTANT NOTES about Maintenance schedule**

1. Re-check tightness of all fasteners after first 2 hours of initial use
2. Change engine oil after first 5-8 hours of initial use
3. Change oil every 25 hours if operating under heavy load or in high temperatures
4. Clean air filter every 10 hours if operating under dusty conditions.

⚠ WARNING

Use only GENUINE replacement parts. Other parts may damage the unit or result in injury.

Maintenance (Continued)

• Save all instructions

B Lubrication

Add a small amount of engine oil to lubricate parts and pivot points.

Refer to “Periodic Maintenance Schedule Table” for time intervals to lubricate parts.

C How to Change the Engine Oil

NOTE: Refer to Figure 10 when following the steps below:

1. Stop the engine and let it cool.
2. Disconnect spark plug wire from the spark plug.
3. Raise the front of the unit, by lowering the height of the front wheels. Refer to “How to Edge Along a Curb”.
4. Insert a flat pan under the edger, underneath the oil drain plug and frame hole.
5. Remove oil dipstick. (See Figure 3)
6. Remove the oil drain bolt and washer.
7. Allow all oil to drain through the frame hole into the pan.

IMPORTANT: Used oil is a hazardous waste. Place oil in a sealed container and take to your local recycling center. Do NOT discard with household waste.

8. Replace and tighten the oil drain plug and washer.
9. To re-fill engine with oil, see engine preparation section “How to Check Oil and Fill to Proper Level.”

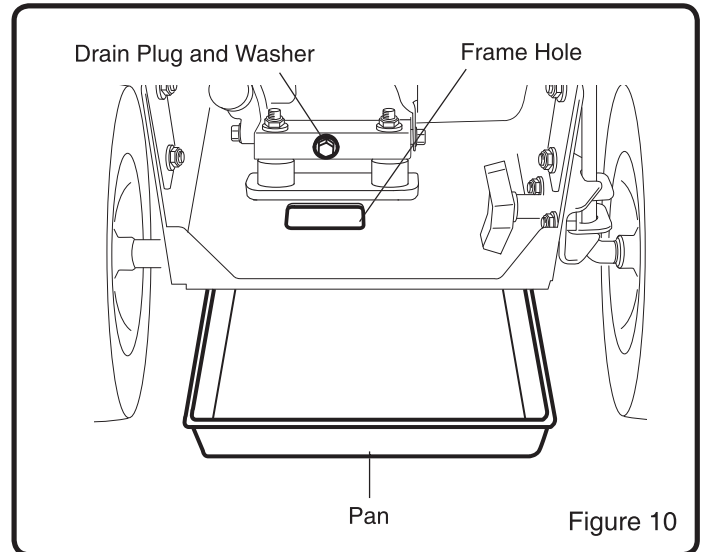

D How to Replace the Belt

1. Disconnect the spark plug wire from the spark plug.
2. To ease the replacement of a belt, remove the control rod (See Figure 2). This will allow the blade arm to rotate back creating slack in the belt.
3. Remove the two rear guard bolts to remove the engine pulley cover. (See Figure 11)

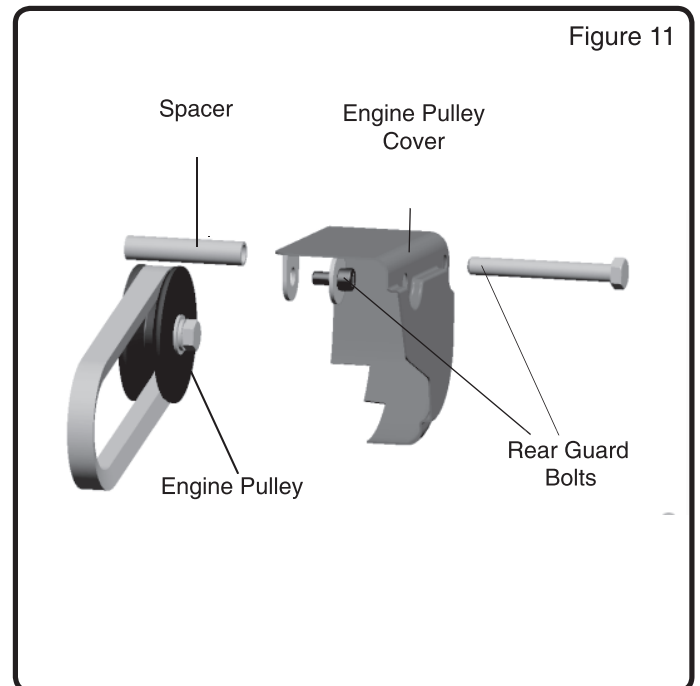

Maintenance (Continued)

• Save all instructions

D How to Replace the Belt (Continued)

4. Remove the two Front Guard Screws and the Belt Guard. (See Figure 12)
 5. Remove the old belt from the engine and quill assembly pulleys.
 6. To install a replacement belt from the manufacturer, reverse the steps above.
- The rear guard bolts should be tightened to 13-16 foot-pounds [18-22 Nm].
 - The front guard screws should be tightened to 4-6 foot-pounds [6-8 Nm].

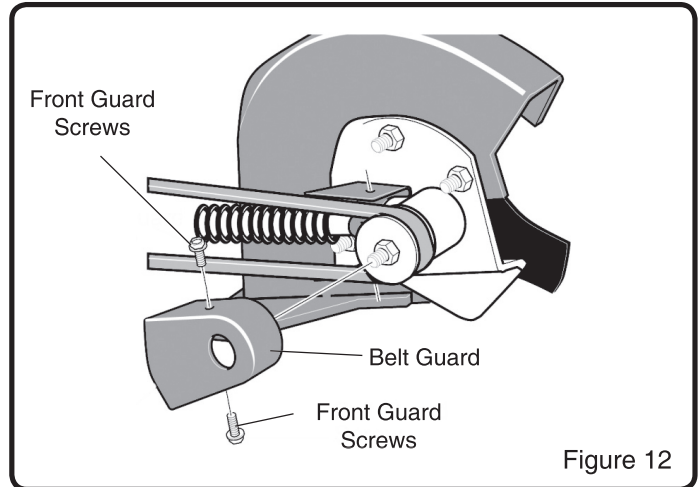

E How to Change the Blade

⚠ WARNING

Do not sharpen the blade. Sharpening can damage the blade and cause it to break, which can cause injury to you or to others.

The blade is subject to nicks, scratches, and dents, which will generally not affect function. The blade is also subject to wear – reducing the cutting depth. Replace a worn blade by following the steps below:

NOTE: Replacing the blade requires two (2) 12" adjustable wrenches, or two (2) 3/4 in. [19mm] wrenches.

1. Shut off engine.
2. Disconnect the spark plug wire from the spark plug.
3. Remove the blade locknut that holds the blade to the drive shaft. (See Figure 13)

⚠ WARNING

To remove or tighten the blade locknut, always use the method shown in Figure 13. Always position the holding wrench on the nut behind the blade.

4. Remove the blade.
5. Replace with a new blade from the manufacturer by reversing the above steps.

Note: Tighten the blade locknut to 35-45 foot-pounds (47-61 N-m).

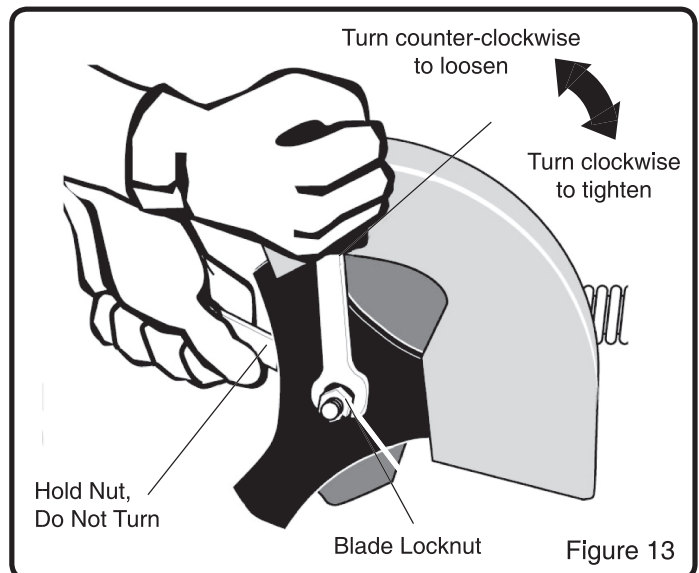

Maintenance (Continued)

• Save all instructions

F How to Clean the Air Filter

A dirty air filter will restrict air intake. Regular maintenance of air cleaner will help improve engine performance and reduce emissions.

⚠ WARNING

Never clean air filter with gasoline or an easy ignited solvent because it may cause explosion.

IMPORTANT: Only use replacement air filter from the manufacturer.

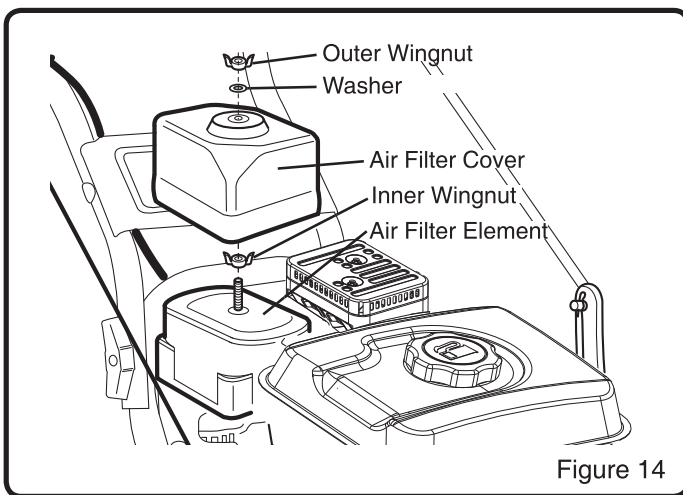

Figure 14

NOTE: Refer to Figure 14 when following steps below:

1. Remove the outer wing nut, washer, and air filter cover.
2. Remove the inner wing nut, and the air filter.

IMPORTANT: Use care when removing the air filter so dirt and debris does not fall into the carburetor.

NOTE: Air filter is made up of an outer foam element and an inner paper element.

3. Separate the outer foam element from the inner paper element.
4. Check the inside of the paper element for dirt or debris.
5. Check both elements for tears.

NOTE: If the inner paper element is dirty or if either element is torn, replace with a new air filter from the manufacturer.

6. Clean the outer foam element by washing it thoroughly in a solution of household detergent and water, or in a nonflammable or high flash point solvent. Allow to dry thoroughly. Then soak the foam element in clean engine oil, and squeeze out all excess oil.
7. Clean the inner paper element by lightly tapping it against a hard surface to remove excess dirt or by blowing compressed air through the filter from the inside out.

IMPORTANT: Do not attempt to brush dirt off the paper element, as this will only embed dirt into the fibers.

8. Reinstall the cleaned out foam element onto the inner paper element.
9. Reinstall the clean air filter and cover onto the unit by reversing steps 1 and 2 above.

G How to Check the Spark Plug

Spark Plug Model: Torch F7RTC

⚠ CAUTION

Only use the recommended spark plug or a spark plug with the same temperature range. Using an improper spark plug, an incorrect spark plug gap, or a dirty/fouled spark plug can reduce engine performance and cause damage.

1. Stop engine and allow it to cool.
2. Remove spark plug wire from spark plug.
3. Use the spark plug wrench and rod (included with edger) to remove the spark plug. (See Figure 15)
4. Visually inspect the spark plug for cracks or damage. If cracked, replace spark plug.
5. Clean carbon deposits. If excessive carbon build up, replace spark plug.
6. Check that the gap of the spark plug is 0.028-0.031 in. (0.7-0.8 mm). (See Figure 16)
7. Re-insert the spark plug and tighten using the spark plug wrench and rod. (See Figure 15)

NOTE: Torque of spark plug is 18-22 foot-pounds (25-30 Nm)

8. Reattach spark plug wire to spark plug.

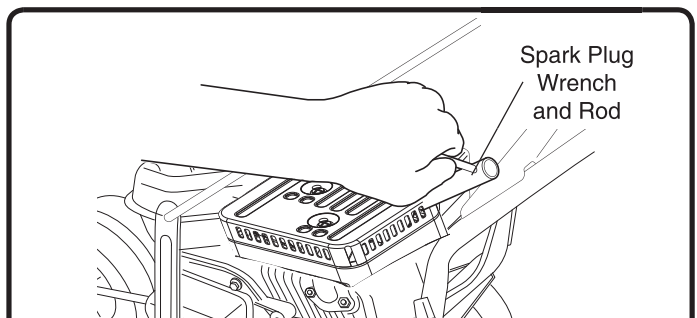

Figure 15

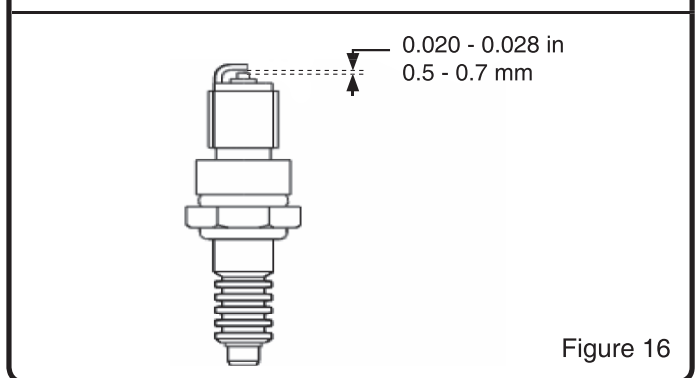

Figure 16

Maintenance *(Continued)*

• Save all instructions

H How to Prepare for Storage

⚠ WARNING

Never store the edger indoors with fuel in the fuel tank. Never store in an enclosed, poorly ventilated area where fumes could reach an open flame, a spark or a pilot light as on a furnace, water heater or clothes dryer. Allow engine to cool before storing unit.

⚠ WARNING

Do not remove gasoline while inside a building, near a fire, or while you smoke. Gasoline fumes can cause an explosion or a fire.

NOTE: A yearly checkup or tune-up at an authorized service center will make sure that the edger will provide maximum performance for the next season.

When the edger is put in storage for thirty days or more, the following steps should be followed to make sure the edger is in good condition the next season.

1. Let the engine run until it is out of gasoline.
2. Change the oil by following instructions under "How to Change the Oil."
3. Remove the spark plug from the cylinder. Pour one ounce of oil into the cylinder. Slowly pull the recoil-start grip so that the oil will protect the cylinder. Install a new spark plug in the cylinder. Pull starter handle slowly a few times to distribute oil. Pull recoil slowly until resistance is felt. This will close the cylinder valves.

⚠ WARNING

DO NOT attach spark plug wire to spark plug when storing unit.

4. Clean edger. Remove all dirt, leaves, debris, grease, etc. from the edger - including cylinder cooling fans, recoil starter cover holes, under fuel tank, and under muffler.
5. Check the edger for worn or damaged parts. Have damaged parts replaced if necessary.
6. Tighten any loose hardware.
7. Apply lubrication as directed in Maintenance section.
8. Put the unit in a building that has good ventilation.
9. Cover the edger with a breathing material.